

# Adept Cobra s350



The Adept Cobra™ s350 robot is a high-performance SCARA robot system for mechanical assembly, material handling, packaging, machine tending, screw driving, and other applications that require fast and precise automation. Adept Cobra s-Series robots include the Adept SmartController™ motion controller, which provides performance capabilities unmatched in the industry.

## Product Features and Benefits

- Adept ACE™ software to deploy your applications through a user-friendly interface
- High-resolution, absolute encoders to provide high accuracy, superior slow-speed following, and easy calibration
- High-efficiency, low-inertia Harmonic Drives™ and a lightweight arm to deliver maximum acceleration
- 8 kHz servo update rate to improve path following and control
- Ethernet TCP/IP capability to control the robot through a PC, PLC, or controller
- Complete interchangeability between robots and controllers
- Available in CR/ESD option for cleanrooms and ESD (prevents static electricity during operation)

## Specifications

Reach	350 mm
Payload	Max. 5 kg
Joint Range	
Joint 1	± 155°
Joint 2	± 145°
Joint 3	200 mm
Joint 4	± 360°
Joint Speeds	
Joint 1	720°/sec
Joint 2	720°/sec
Joint 3	2000 mm/sec
Joint 4	2400°/sec
Repeatability	
XY	± 0.015 mm
Z	± 0.01 mm
Theta	± 0.005°
Pass-Through Connections	
Electrical	19 conductors
Pneumatic	6 mm (x2) 4 mm (x2)
Weight	20 kg
Environmental Requirements	
Ambient Temperature	5 - 40 °C
Humidity Range	5 - 90 % (non-condensing)
Power Requirements SmartController	24 VDC : 5 A
Power Requirements for eMotionBlox40R	24 VDC : 6 A 200 - 240 VAC : 10 A, single-phase
CE Compliant	



The Adept Cobra s350 robot comes with the high-performance Adept SmartController™ motion controller, which is based on the Adept SmartServo architecture. It has a small footprint of 329w x 187d x 86h mm.

# ADEPT COBRA s350

## Dimensions Adept Cobra s350 (mm)

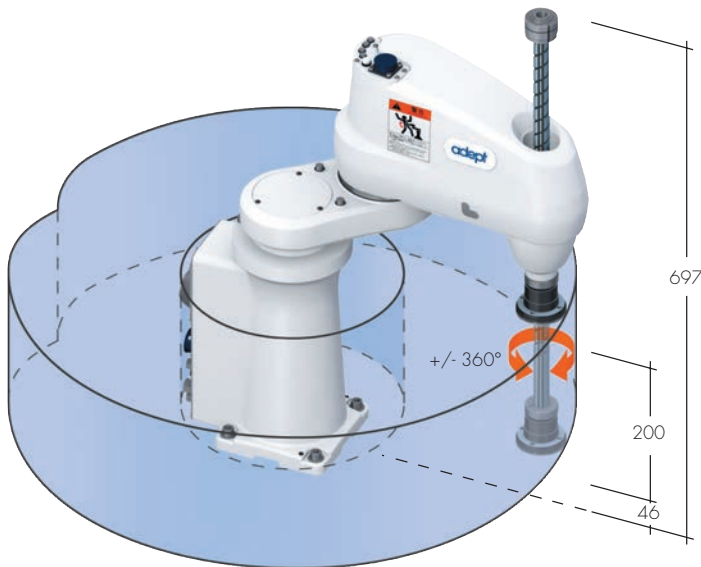

## Dimensions eMotionBlox-40R (mm)



## Dimensions: Flange (mm)

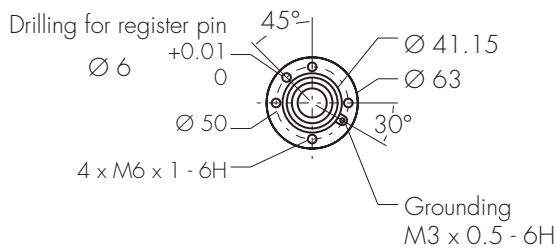

## Dimensions: Footprint (mm)

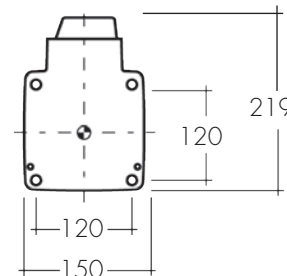

## The Adept Cobra s350 system includes the following:

- Adept Cobra s350 robot
- Adept SmartController™ motion controller
- eMotionBlox-40R servo controller and amplifiers
- Front panel with E-Stop
- Adept ACE™ software
- User documentation

## Options and Peripherals:

- AdeptSight™ vision guidance and inspection system (requires a PC—Adept recommends using the Adept SmartVision™ MX)
- T20 manual control pendant
- Dual robot configuration option
- Conveyor-tracking option
- sM16 SmartMotion™ interface
- sDIO I/O expansion (32 digital input and 32 digital output channels)
- IO Blox I/O module (8 digital input and output channels each)
- Solenoid valve kit
- Cleanroom ISO4 (class 10) option/ ESD option

## Downloads:

Download CAD files for the Adept Cobra s350 robot from <http://www.adept.com/>



**Adept Technology, Inc.** 5960 Inglewood Drive, Pleasanton, CA 94588

Tel: 925-245-3400 Fax: 925-960-0452 Email: [info@adept.com](mailto:info@adept.com)

[www.adept.com](http://www.adept.com)

Specifications subject to change without notice.

©2015 Adept Technology, Inc. ALL RIGHTS RESERVED. The information provided in this communication or document is the property of Adept Technology, Inc. and is protected by copyright and other intellectual property laws. In addition, any references to any Adept Technology, Inc. products are the marks and property of Adept Technology, Inc. [and may be registered trademarks]. All other trademarks or tradenames are the property of their respective holders.