

Adept Cobra ePLC350



Allen-Bradley PLC



Siemens PLC

The Adept Cobra™ ePLC350 robot is a compact, high-performance, 4-axis, SCARA robot. Adept's ePLC robots natively run Adept ePLC Connect™ software, which allows them to communicate directly with an existing Programmable Logic Controller (PLC). This ePLC configuration allows users to install, program, operate and support our high-performance robots using the familiar interface of their existing PLC. Adept ePLC robots are designed to provide significant cost and time savings for users with new or existing PLC automation systems.

Specifications

Reach	350 mm
Payload	
Rated	2 kg
Max.	5 kg
Joint Range	
Joint 1	± 155°
Joint 2	± 145°
Joint 3	200 mm
Joint 4	± 360°
Joint Speeds	
Joint 1	720°/sec
Joint 2	720°/sec
Joint 3	2000 mm/sec
Joint 4	2400°/sec
Repeatability	
XY	± 0.015 mm
Z	± 0.01 mm
Theta	± 0.005°
Pass-Through Connections	
Electrical	19 conductors
Pneumatic	6 mm (x2) 4 mm (x2)
Weight	20 kg
Environmental Requirements	
Ambient Temperature	5 - 40 °C
Humidity Range	5 - 90 % (non-condensing)
Digital I/O Channels	
eMB-40R:	12 inputs, 8 outputs
Power Requirements for eMotionBlox-40R	
24 VDC	: 6 A
200 - 240 VAC	: 10 A, single-phase
CE Compliant	

Product Benefits

- Lower system cost due to controller-less operation
- Rapid deployment using familiar ladder logic programming languages of existing PLC (IEC 61131-3)
- Maximum facility utilization with the most compact system footprint in the industry
- Increased facility safety and lower cost with minimal power and signal cabling requirements

Product Features

- Compatible with 1756 ControlLogix® or CompactLogix™ (by Allen-Bradley) and S7-300 SIMATIC (by Siemens) PLCs
- High-resolution, absolute encoders to provide high accuracy, superior slow-speed following, and easy calibration
- High-efficiency, low-inertia Harmonic Drives™ and a lightweight arm to deliver maximum acceleration
- 8 kHz servo update rate to improve path following and control
- Integrated 10/100 Base-T Ethernet for EtherNet/IP™ communication

ADEPT COBRA ePLC350

Dimensions: Adept Cobra ePLC350 (mm)

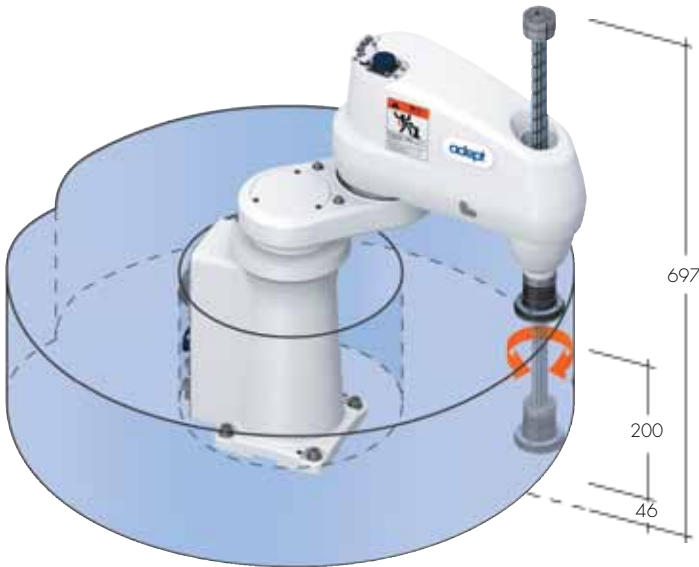

Dimensions: eMotionBlox-40R (mm)



Dimensions: Flange (mm)

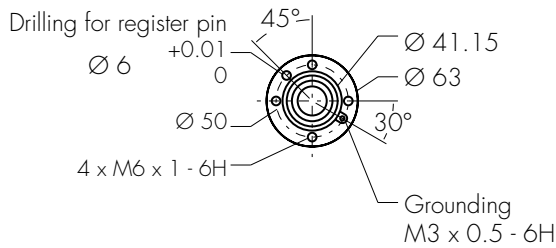

Dimensions: Footprint (mm)

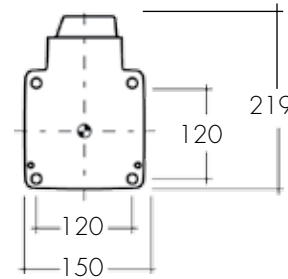

The Adept Cobra ePLC350 system includes the following:

- Adept Cobra ePLC350 robot
- eMotionBlox-40R servo controller and amplifiers
- Front panel with E-Stop
- Adept ACE™ software
- User documentation
- Cables to connect E-Stop and other peripherals

Options and Peripherals:

- AdeptSight™ vision guidance and inspection system
- T20 manual control pendant
- Solenoid valve kit
- Cleanroom ISO4 (class 10) option/ESD option

Downloads:

Download CAD files for the Adept Cobra ePLC350 robot from <http://www.adept.com/support/downloads/file-search>

Optional T20 Manual Control Pendant:



Adept Technology, Inc. 5960 Inglewood Drive, Pleasanton, CA 94588

Tel: 925-245-3400 Fax: 925-960-0452 Email: info@adept.com

www.adept.com

Specifications subject to change without notice.

©2014 Adept Technology, Inc. ALL RIGHTS RESERVED. The information provided in this communication or document is the property of Adept Technology, Inc. and is protected by copyright and other intellectual property laws. In addition, any references to any Adept Technology, Inc. products are the marks and property of Adept Technology, Inc. [and may be registered trademarks]. All other trademarks or tradenames are the property of their respective holders.